

**"INDEX" FOR CROSS SECTIONS  
(A-A, B-B, B-1-B1, C-C, C-2-C2, D-D)**

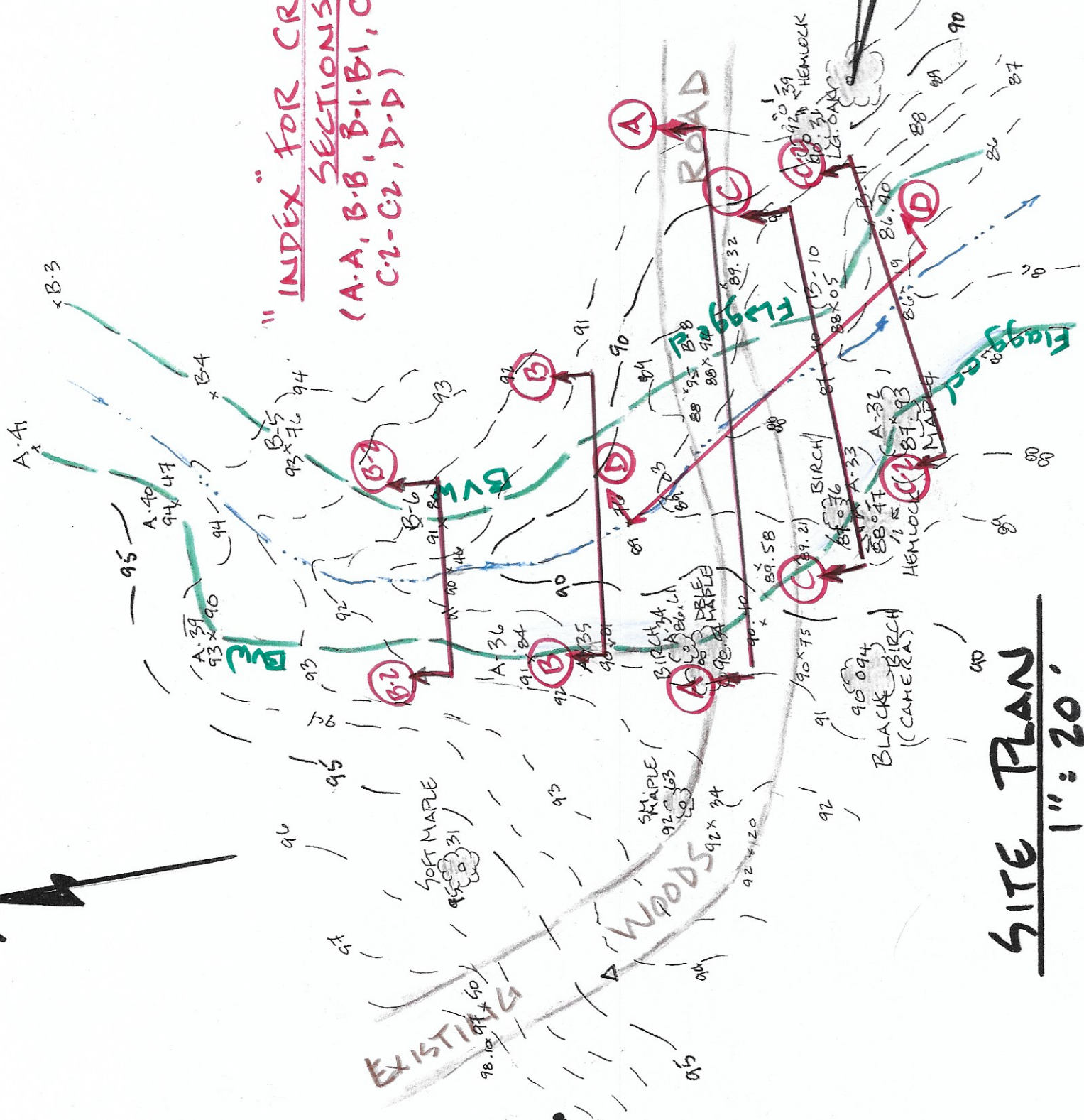

TBM # 2  
NAIL IN  
OAK. UP  
EL = 91.55

TBM # 1  
TOP of Set  
STAKE, UP  
17" EL. 100.00

**SITE PLAN**  
1" = 20'